

# STEEL SLATBAND CHAINS

## MaxxTop Series 881 Sideflex Bevel

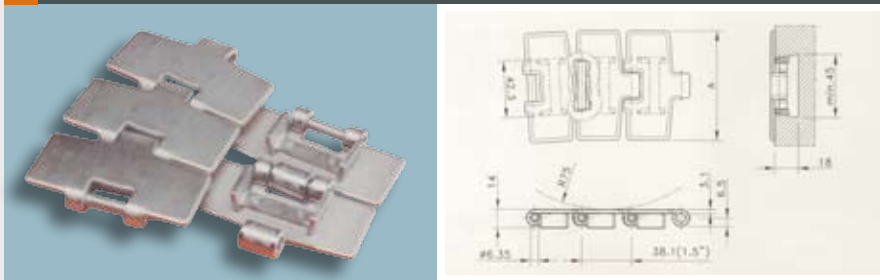

Chain material	Mega
Pin material	Stainless Steel hardenend
Plate thickness	3.1mm
Pin diameter	6.35mm
Back flex radius	80mm
Min. curve radius	500mm / 18"
Standard length	80 Pitches (10 feet-3.048mm)

Chain ref	Material	Width		Average yield load		Weight	
		mm	inches	N	lbf	kg/m	lb/ft
Mega8810-K325	Mega	82,5	3 ¼	8.000	1.80	2,90	1,95
Mega8810-K450		114,3	4 ½			3,60	2,42
Mega8810-K750		190,5	7 ½			5,30	3,56

# SPROCKETS

## SIDEFLEX TAB SPLIT SPROCKETS



SPK 128  
SPK 129

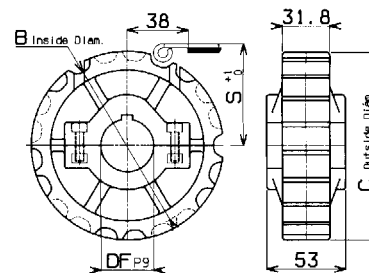

Sprocket type	No of teeth	Bore	Pitch diam. B	Outside diam. C	Width	Hub width	Chain height S
		mm					
SPK / 128 / 25	21	25	116.1	129.5	31.8	53.0	67.8
SPK / 128 / 30	21	30					
SPK / 128 / 35	21	35					
SPK / 128 / 40	21	40					
SPK / 128 / 45	21	45					
SPK / 129 / 25	25	25	140.1	154.2	31.8	53.0	79.8
SPK / 129 / 30	25	30					
SPK / 129 / 35	25	35					
SPK / 129 / 40	25	40					
SPK / 129 / 45	25	45					

## SIDEFLEX TAB SPLIT SPROCKET IDLER



SPK 128 IDL  
SPK 129 IDL

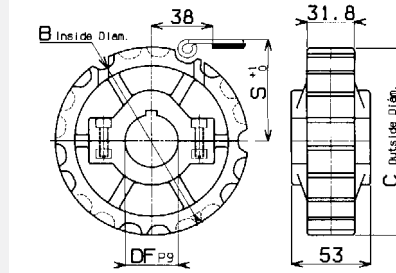

Sprocket type	No of teeth	Bore	Pitch diam. B	Outside diam. C	Width	Hub width	Chain height S
		mm					
SPK / 128 / IDL / 25	21	25	116.1	129.5	31.8	53.0	67.8
SPK / 128 / IDL / 30	21	30					
SPK / 128 / IDL / 35	21	35					
SPK / 128 / IDL / 40	21	40					
SPK / 128 / IDL / 45	21	45					
SPK / 129 / IDL / 25	25	25	140.1	154.2	31.8	53.0	79.8
SPK / 129 / IDL / 30	25	30					
SPK / 129 / IDL / 35	25	35					
SPK / 129 / IDL / 40	25	40					
SPK / 129 / IDL / 45	25	45					