



POWERED BY

**SYSTEM
FLEX** CONVEYOR
COMPONENT
SOLUTIONS



**REVERSE ENGINEERING & ALTERNATE MATERIAL
MANUFACTURER (AMM)**

BOTTLING & BEVERAGE FILLING SOLUTIONS

For IRP's full product range, detailed information and engineering manual,
download IRP's full catalogue @ www.irp.co.za

WHY IRP?

VALUE PROPOSITION

PROBLEM SOLVERS AND SOLUTIONS PROVIDERS.

- Are you struggling to source the correct conveyor solutions?
- Not enough expertise to guide and advise you on the correct solutions?
- Are current suppliers and OEM's letting you down leading to unnecessary down-time and inefficient production?
- Are you over spending on maintenance budgets?

HOW WE ADD VALUE . . .

- Being South Africa's largest local manufacturer in our field, we have the advantage of providing competitive solutions over OEM's, providing you maximum return on investment.
- With over 30 years of providing solutions to the food, beverage and packaging industries, IRP has the expertise to guide and advise on the correct solutions.
- IRP provides extensive audits to assess current conveyor and production set-ups in order to provide the correct conveyor solutions.
- With your production at the center of our focus, we at IRP pride ourselves on customer satisfaction and delivery.

ABOUT IRP

COMPANY OVERVIEW

IRP Engineering PlasticsCC was founded in 1987 and has been the industry leader in Engineering Plastics ever since. An opportunity was recognized for the real need in local manufacturing of plastic conveyor components used by the food, beverage and packaging industries, which had previously been sourced from Europe and America.

IRP's Manufacturing capabilities has continually developed over the years and now consists of a full CNC manufacturing Division, Injection Moulding Division, Belt, Chain and Component Assembly Division and a Stock Holding Division with more than 2000 conveyor components.

IRP's Injection moulding facility consists of injection moulding machines ranging from 50 ton to 360 ton capacities and is complete with a fully operational tool room to handle injection moulding projects from start to the finished product.

IRP's CNC Manufacturing Division is dedicated to producing custom made parts and comprises, CNC Lathes, CNC Machining Center's and CNC Vacuum Bed Routers complete with 4th Axis capabilities. All machines are linked to sophisticated Autocad and CNC programming systems for superior accuracy and speedy delivery.

IRP's Technical Design Centre is equipped with the Cimcore II portable measuring arm which is the latest in portable measuring technology. Cimcore II enables IRP to accurately reverse engineer any complex parts with ease which can be done on-site, reducing down-time or a tour Technical Design Centre.

IRP's Modular Belting and Chain Assembly Division has over 10 dedicated assembly lines locally producing standard modular belts and non-standard made to width modular belts and chains. IRP's Modular Belting and Chain Assembly Division boasts a modular belting range that consists of a 12mm pitch, 15mm pitch, 25,4mm pitch, 31.75mm pitch and 50.8mm pitch belts in both straight running and side flexing applications. IRP locally produce and supply the full range of plastic, stainless steel slatband chains and crate conveyor chains. IRP's range of modular belting and chains has been used and supplied extensively to all food, beverage and packaging industries over the last 25 years.

IRP supply a wide range of nylon stock shapes and is capable of supplying sheet sizes 2600mm x 1300mm up to 100mm thick with Nylon rods and tubes that can be produced up to 1000mm in diameter. IRP's Nylon (Polyamide) range consists of Molybdenum, Oil and Wax filled grades that increases wear resistance and reduces friction. This Nylon is commonly used in parts such as change parts, bottle feed equipment for bottling and canning plants, corner tracks, wearstrips and bearing applications.

MISSION STATEMENT

To continually strive for customer satisfaction brought about by being a World Class Supplier of conveyor components for use in the food, beverage and packaging industries, by offering technical assistance based on experience and know-how and by developing innovative solutions that both enhance the customers' business as well as our own.

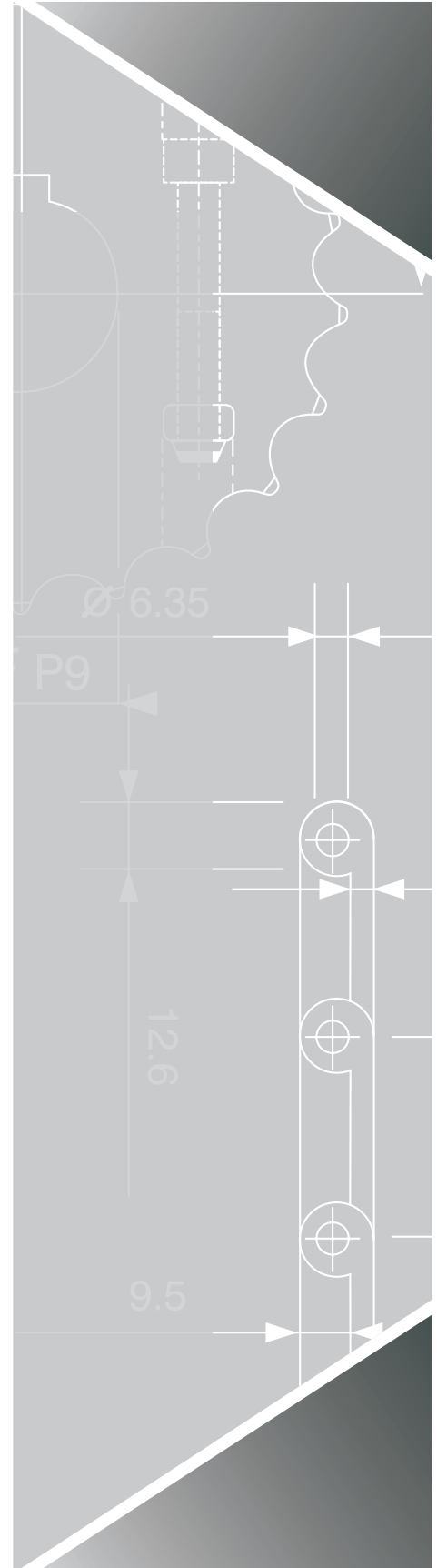



CORE SERVICES WE OFFER

IRP Engineering Plastics offers a wide range of services that set us apart from our competitors.

- Urgent/breakdown manufacturing service
- Cost-effective and competitive solutions that reduce maintenance budgets
- Local stockholding for urgent supply, preventing downtime
- Locally manufactured solutions for on-demand supply
- Unrivalled service, support and advice to keep production running



PRODUCTS WE SUPPLY

IRP Engineering Plastics produce and stock a broad selection of conveyor components that service and supply the food, beverage and packing industry.

- Stainless Steel Table Top chains
- Plastic Table Top Chains
- Sprockets and Idlers
- Conveyor Components
- Guide Rail Systems
- Bends and Straight Tracks
- Modular Belting
- Bottle, Can & Jar Product Filling Equipment
- Specially Machined Components
- Wear Strips & Chain Guides
- Conveyor Building & Automation



INDUSTRIES WE SERVE

IRP Engineering Plastics produce and stock a broad selection of conveyor components that service and supply a wide variety of industries.

- Bottling & Beverage Filling
- Meat, Fish & Poultry Processing
- Fruit & Vegetable Processing
- Materials Handling & Packaging
- Glass Handling
- Bakery
- Confectionery
- Dairy
- Pharmaceutical
- Aerosol
- Corrugated Packaging

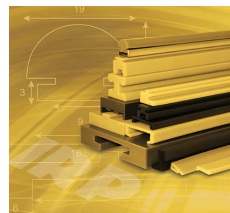
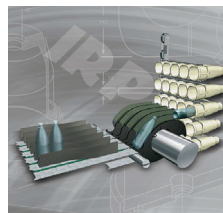
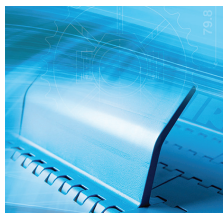
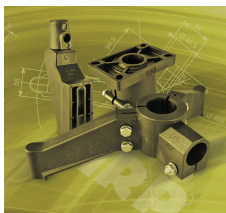

OVERVIEW OF THE SOLUTIONS WE PROVIDE

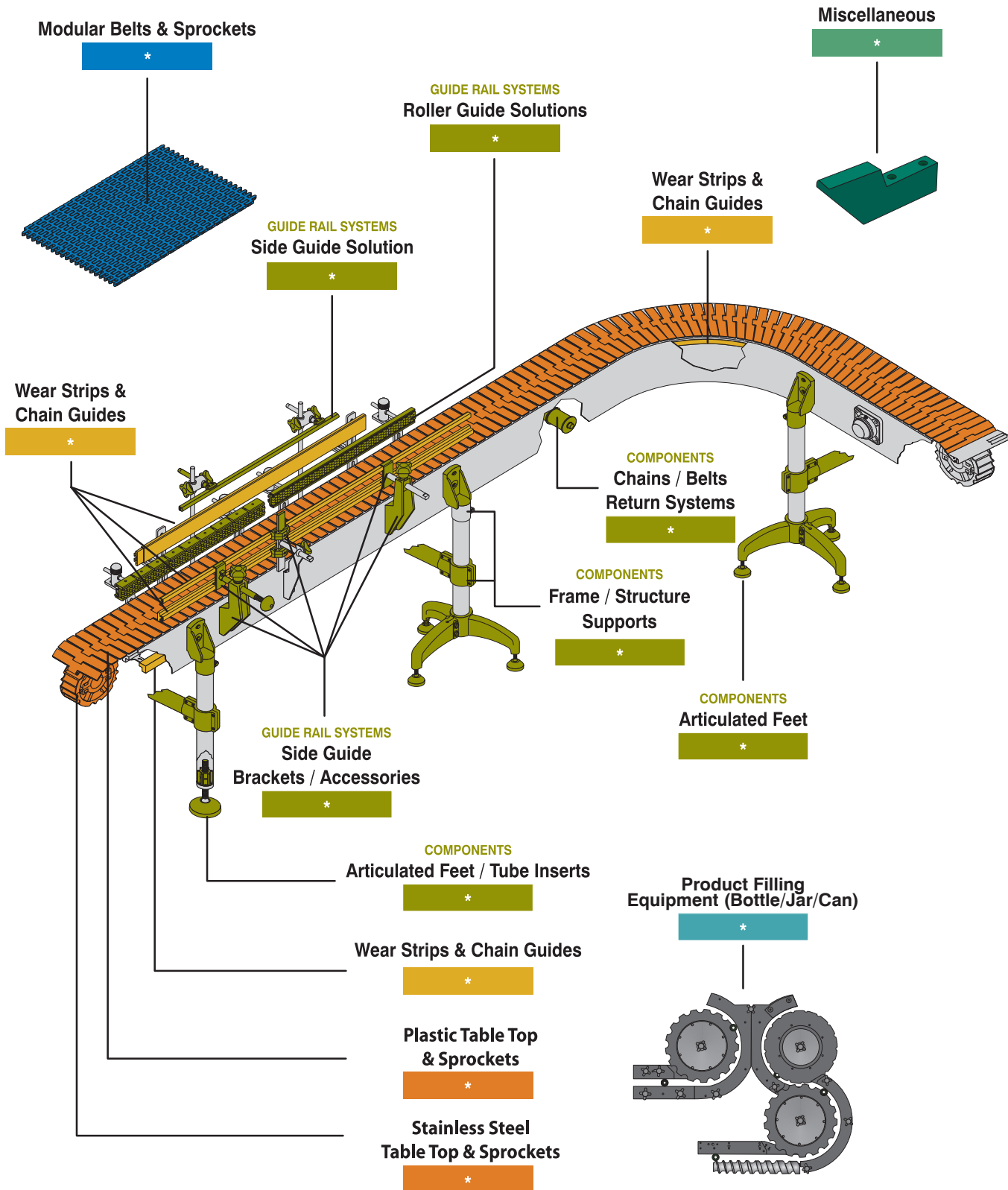

MAGNETIC FLEX: CURVES & STRAIGHT TRACKS

LFC/039, LFC/040, LFC/041

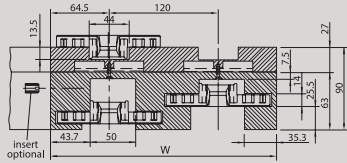

LFC/044, LFC/045, LFC/046

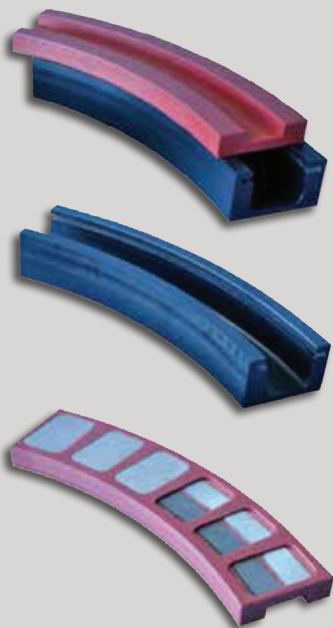
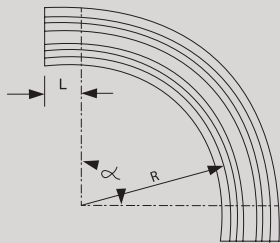
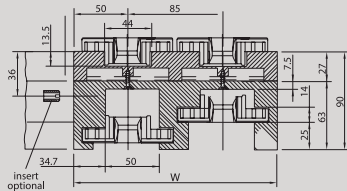

Code	Number of Tracks	1 (mm)	1 (mm)	1 (mm)	1 (mm)	1 (mm)	1 (mm)
	Degree of Bend	Width	Width	Width	Width	Width	Width
MAGNETIC FLEX CURVES FOR 3.25" 2540 SERIES							
IRP. 10.3.3.15-K325-30	30°	100	185	270	355	440	525
IRP. 10.3.3.15-K325-45	45°	100	185	270	355	440	525
IRP. 10.3.3.15-K325-90	90°	100	185	270	355	440	525

MAGNETIC FLEX CURVES FOR 4.5" 2540 SERIES							
IRP. 10.3.3.15-K450-30	30°	129	249	369	489	-	-
IRP. 10.3.3.15-K450-45	45°	129	249	369	489	-	-
IRP. 10.3.3.15-K450-90	90°	129	249	369	489	-	-

Code	Chain Type	Radius R	Pitch P	Basic Width B	Infeed Length L	Total Height H
		mm	mm	mm	mm	mm
FOR CHAINS WITH 3.25"/3.30" PLATE WIDTH						
IRP. 10.0.3.15-K325-90	Steel/Plastic	500	85	100	0	82/90
					100	90
		500	89	100	100	90
					100	100
		500	90	100	100	82
					110	82
		590	180	100	100	82
					100	82
		680	-	100	100	82
					100	82
750	85	111	100	90		
			100	90		
860	-	100	125	82		
			100	82		
1000	-	100	0	82		
			100	90		
IRP. 10.0.3.15-K325-90	Steel	500	85	111	100	100

FOR CHAINS WITH 4.5" PLATE WIDTH						
IRP. 10.3.3.5-K450-90	Steel/Plastic	500	120	129	125	90
		610	120	129	125	90

FOR CHAINS WITH 7.5" PLATE WIDTH						
IRP. 10.0.3.15-K325-90	Steel	610	196	214	125	90
		860	-	214	0	82
		1000	-	214	0	82
	Steel/Plastic	610	195	200	100	95
		860	-	214	0	87

FOR CHAINS WITH 10.5" PLATE WIDTH						
IRP. 10.0.3.15-K325-90	Plastic	860	-	290	0	87

FOR CHAINS WITH 12.0" PLATE WIDTH						
IRP. 10.0.3.15-K325-90	Plastic	860	-	340	0	87

MISCELLANEOUS	CODE	DESCRIPTION
	INF/CAM/SMALL	KHS ALTERNATIVE INFEEED CAMS - SMALL
	DIS/CAM/LARGE	KHS ALTERNATIVE DISCHARGE CAMS - LARGE
	INFEED/FINGERS	SIMONAZZI ALTERNATIVE INFEEED FINGERS
	INFEED/FINGERS/MACH	INFEEED FINGERS MACHINED
	SUPPORT/PIECES	KHS, KRONES & SIMONAZZI ALTERNATIVE SUPPORT PIECES
	FEED/DIS/FINGERS/208 FEED/DIS/FINGERS/228	KHS, KRONES & SIMONAZZI ALTERNATIVE INFEEED & DISCHARGE FINGERS
	FEED/DIS/FINGERS/*	KHS, KRONES & SIMONAZZI ALTERNATIVE INFEEED & DISCHARGE FINGERS
	FEED/DIS/FINGERS/*/*	KHS, KRONES & SIMONAZZI ALTERNATIVE INFEEED & DISCHARGE FINGERS
	POCKET/TYPE/*/*	KHS & SIMONAZZI ALTERNATIVE POCKETS & INSERTS FOR BOTTLE WASHERS

MISCELLANEOUS	CODE	DESCRIPTION
	IRP-POCKET/INSERT/TYPE8	O&H ALTERNATIVE BOTTLE WASHER POCKET / NOSE CONE
	NECK/GUIDES	KRONES & SYSTEMPLAST ALTERNATIVE BOTTLE NECK GUIDES
	PICK/UP/HEAD/ *	KHS, KRONES, OROBICA ALTERNATIVE PICK UP HEADS - COMPLETE
	SL/N/SIM	SIMONAZZI ALTERNATIVE SWITCH LEVERS
	CHAIN/GUIDE/*	CHAIN GUIDES / TENSIONERS
	TURNING/FORK/*	KRONES ALTERNATIVE TURNING FORKS
	BOTTLE/PLATFORM/*	KHS & KRONES ALTERNATIVE BOTTLE PLATFORMS
	BOTTLE/PAD/*	KHS & KRONES ALTERNATIVE BOTTLE PADS
	UPPER/TULIP	KHS, KRONES & SIDEL ALTERNATIVE UPPER PART OF CENTERING TULIPS
	LOWER/TULIP	KHS, KRONES & SIDEL ALTERNATIVE LOWER PART OF CENTERING TULIPS
	SUC/CUP/NT	KHS & KRONES ALTERNATIVE TULIP SLEEVES / SUCTION CUPS
	SUC/CUP/TR	KHS & KRONES ALTERNATIVE TULIP SLEEVES / SUCTION CUPS
	8-RING/PTFE/BELLOW	KRONES ALTERNATIVE PTFE BELLOWS / DIAPHRAGMS
	ROLLER/*/*/*	KHS & KRONES ALTERNATIVE LIFT CYLINDER ROLLERS / PULL DOWN ROLLERS

KHS ALTERNATIVE - INFEEED CAM

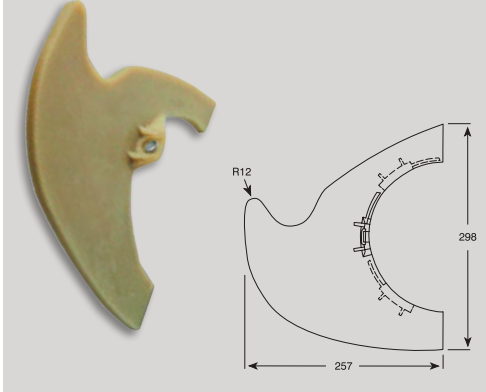

SPECIFICATIONS

Material Reinforced Polyamide

Component Reference

INF/CAM/SMALL

KHS ALTERNATIVE DISCHARGE CAM - LARGE



SPECIFICATIONS

Material Reinforced Polyamide

Component Reference

DIS/CAM/LARGE

SIMONAZZI ALTERNATIVE INFEEED FINGER

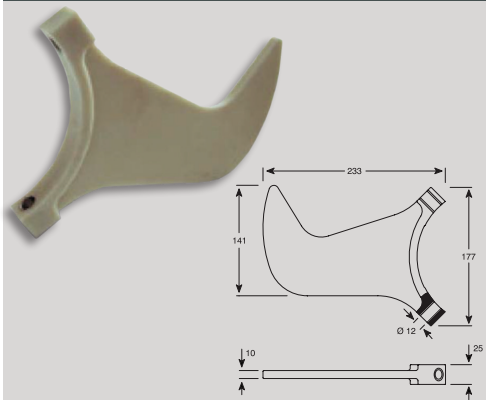

SPECIFICATIONS

Material Reinforced Polyamide

Component Reference

INFEEED/FINGER

MACHINED INFEEED FINGERS

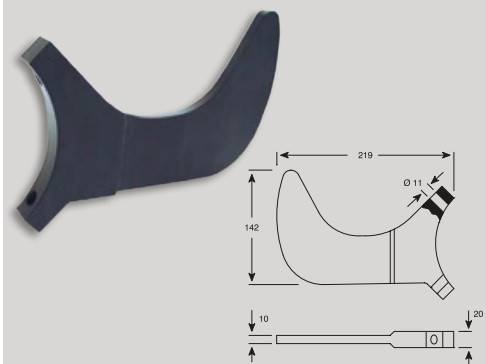

SPECIFICATIONS

Material Reinforced Polyamide/UHMWPE

Component Reference

INFEEED/FINGER/MACH

KHS, KRONES & SIMONAZZI ALTERNATIVE SUPPORT PIECES

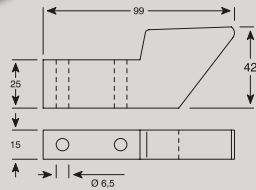
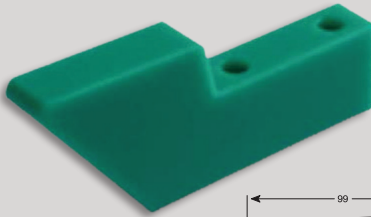

SPECIFICATIONS

Material: UHMWPE

Component Reference

SUPPORT/PIECES

KHS, KRONES & SIMONAZZI ALTERNATIVE INFEEED & DISCHARGE FINGERS

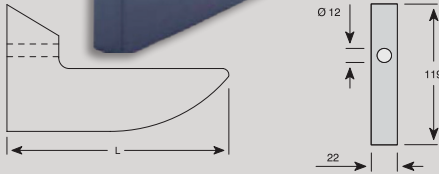
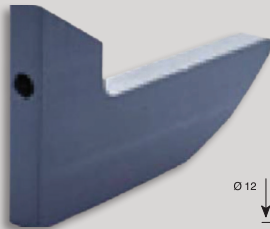

SPECIFICATIONS

Material: Reinforced Polyamide/ UHMWPE

Component Reference

Length (mm)

FED/DIS/FINGERS/208	208
FED/DIS/FINGERS/228	228

KHS, KRONES & SIMONAZZI ALTERNATIVE INFEEED & DISCHARGE FINGERS

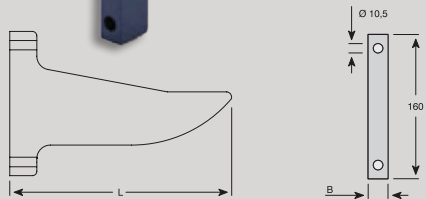

SPECIFICATIONS

Material: Reinforced Polyamide/ UHMWPE

Component Reference

Dimensions

Component Reference	Dimensions	
	L (mm)	B (mm)
FED/DIS/FINGERS/268/20	268	20
FED/DIS/FINGERS/246/22	246	22

KHS, KRONES & SIMONAZZI ALTERNATIVE INFEEED & DISCHARGE FINGERS

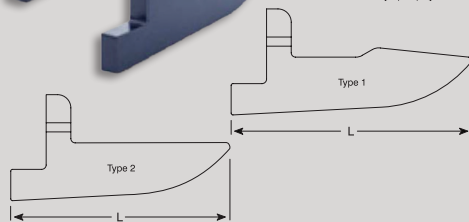

SPECIFICATIONS

Material: Reinforced Polyamide/ UHMWPE

Component Reference

Dimensions

Component Reference	Dimensions	
	L (mm)	B (mm)
FED/DIS/FINGERS/248/TYPE2	248	2
FED/DIS/FINGERS/267/TYPE2	267	2
FED/DIS/FINGERS/272/TYPE1	272	1

BOTTLE WASHER POCKETS

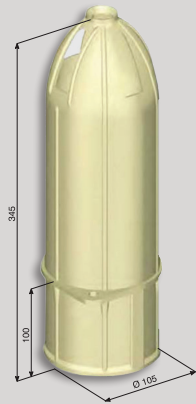
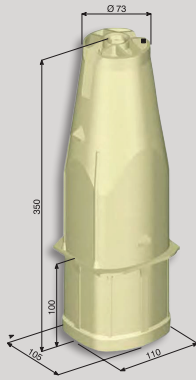
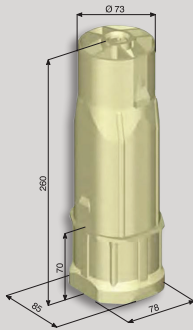

KHS ALTERNATIVE BOTTLE WASHER POCKETS

SPECIFICATIONS

Material: Specially formulated Polypropylene

Component Reference

IRP-POCKET/TYPE1

Component Reference

IRP-POCKET/TYPE7

Component Reference

IRP-POCKET/TYPE6

O&H ALTERNATIVE POCKET INSERT/NOSE CONE

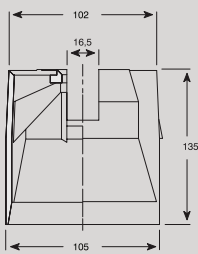
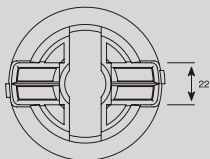

SPECIFICATIONS

Material: Specially formulated Polypropylene

Component Reference

IRP-POCKET/INSERT/TYPED

KRONES & SYSTEMPLAST ALTERNATIVE NECK GUIDES

Our wear and sliding optimised polyethylene UHMWPE, with characteristic features such as:

- High abrasion resistance

- High notched impact strength
- Low coefficient of friction
- High chemical and corrosion resistance
- No absorption of humidity
- Absorbing vibration and noise
- Special angles, colours and designs available upon request.

SPECIFICATIONS

Material UHMWPE

Component Reference	Angle α	Radius 1 mm	Side of the Turn
NECK/GUIDE/OUTSIDE/500CL/15-DEG	15°	500	Outside
NECK/GUIDE/INSIDE/500CL/15-DEG			Inside
NECK/GUIDE/OUTSIDE/500CL/30-DEG	30°		Outside
NECK/GUIDE/INSIDE/500CL/30-DEG			Inside
NECK/GUIDE/OUTSIDE/500CL/45-DEG	45°		Outside
NECK/GUIDE/INSIDE/500CL/45-DEG			Inside
NECK/GUIDE/OUTSIDE/500CL/60-DEG	60°		Outside
NECK/GUIDE/INSIDE/500CL/60-DEG			Inside
NECK/GUIDE/OUTSIDE/500CL/75-DEG	75°		Outside
NECK/GUIDE/INSIDE/500CL/75-DEG			Inside
NECK/GUIDE/OUTSIDE/500CL/90-DEG	90°		Outside
NECK/GUIDE/INSIDE/500CL/90-DEG			Inside
NECK/GUIDE/OUTSIDE/750CL/15-DEG	15°	750	Outside
NECK/GUIDE/INSIDE/750CL/15-DEG			Inside
NECK/GUIDE/OUTSIDE/750CL/30-DEG	30°		Outside
NECK/GUIDE/INSIDE/750CL/30-DEG			Inside
NECK/GUIDE/OUTSIDE/750CL/45-DEG	45°		Outside
NECK/GUIDE/INSIDE/750CL/45-DEG			Inside
NECK/GUIDE/OUTSIDE/750CL/60-DEG	60°		Outside
NECK/GUIDE/INSIDE/750CL/60-DEG			Inside
NECK/GUIDE/OUTSIDE/750CL/75-DEG	75°		Outside
NECK/GUIDE/INSIDE/750CL/75-DEG			Inside
NECK/GUIDE/OUTSIDE/750CL/90-DEG	90°		Outside
NECK/GUIDE/INSIDE/750CL/90-DEG			Inside
NECK/GUIDE/OUTSIDE/1000CL/15-DEG	15°	1000	Outside
NECK/GUIDE/INSIDE/1000CL/15-DEG			Inside
NECK/GUIDE/OUTSIDE/1000CL/30-DEG	30°		Outside
NECK/GUIDE/INSIDE/1000CL/30-DEG			Inside
NECK/GUIDE/OUTSIDE/1000CL/45-DEG	45°		Outside
NECK/GUIDE/INSIDE/1000CL/45-DEG			Inside
NECK/GUIDE/OUTSIDE/1000CL/60-DEG	60°		Outside
NECK/GUIDE/INSIDE/1000CL/60-DEG			Inside
NECK/GUIDE/OUTSIDE/1000CL/75-DEG	75°		Outside
NECK/GUIDE/INSIDE/1000CL/75-DEG			Inside
NECK/GUIDE/OUTSIDE/1000CL/90-DEG	90°		Outside
NECK/GUIDE/INSIDE/1000CL/90-DEG			Inside

Colours Depending on stock

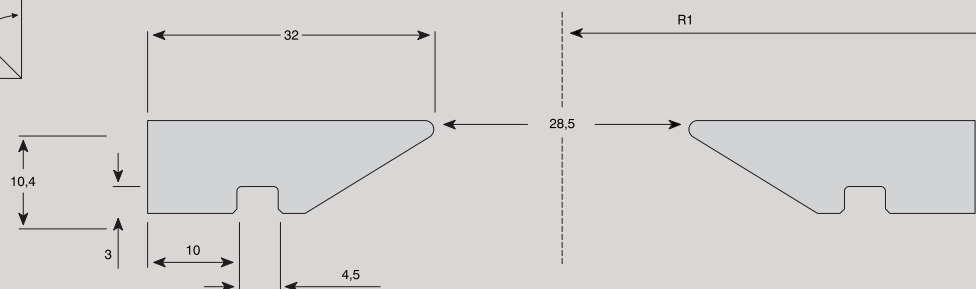
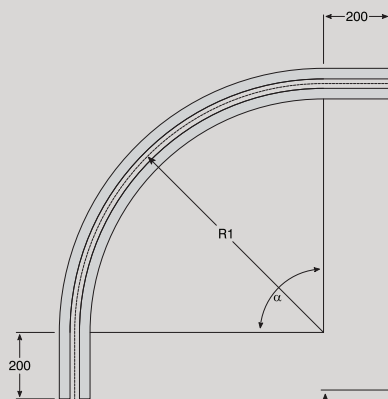

DIA=45MM

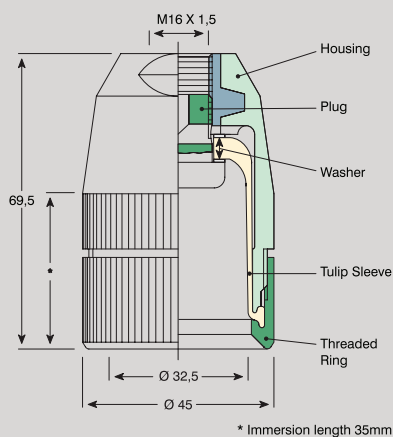

KRONES, KHS & OROBICA ALTERNATIVE PICK UP HEADS COMPLETE

SPECIFICATIONS

Component Reference

PICK/UP/HEAD/45DIA

Gripper Bell in Reinforced Plastic:

Excellent material for our gripper bells.

The housing and parts of our gripper bells are of high quality engineering plastics and equipped with tulip sleeves made of well-chosen elastomers, which offer outstanding mechanical properties such as:

- Excellent resistance to mechanical wear
- Good tear propagation resistance
- Low compression set
- High adhesion and grip
- Elasticity and flexibility

Especially suitable for:



DIA=54/60/68MM

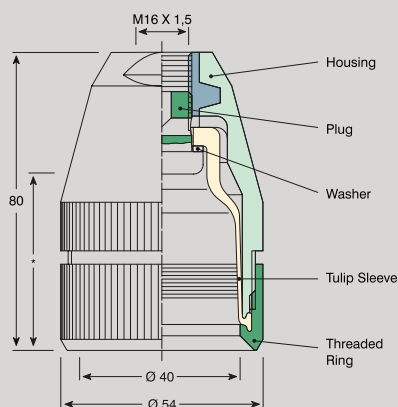

KRONES, KHS & OROBICA ALTERNATIVE PICK UP HEADS COMPLETE

SPECIFICATIONS

Component Reference

PICK/UP/HEAD/54DIA

PICK/UP/HEAD/60DIA

PICK/UP/HEAD/68DIA

Especially suitable for:

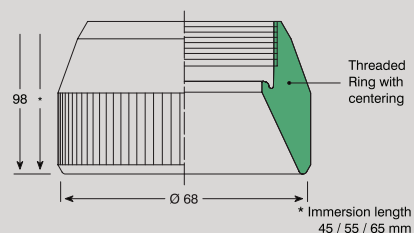
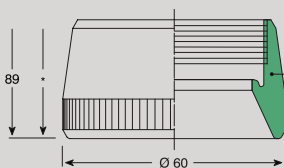

DIA=58MM

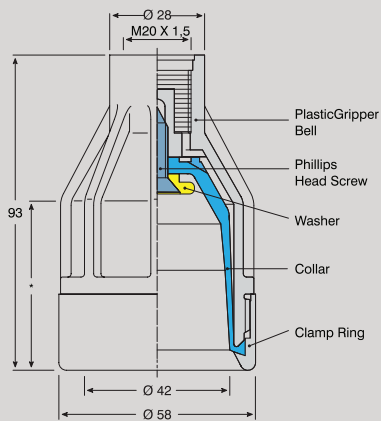

* Immersion length 50 / 58 mm

KRONES, KHS & OROBICA ALTERNATIVE PICK UP HEADS COMPLETE

SPECIFICATIONS

Material Reinforced Polyamide

Component Reference

PICK/UP/HEAD/58DIA

Gripper Bell in Reinforced Plastic:

Excellent material for our gripper bells.

The housing and parts of our gripper bells are of high quality engineering plastics and equipped with tulip sleeves made of well-chosen elastomers, which offer outstanding mechanical properties such as:

- Excellent resistance to mechanical wear
- Good tear propagation resistance
- Low compression set
- High adhesion and grip
- Elasticity and flexibility

Especially suitable for:



SIMONNAZI ALTERNATIVE SWITCH LEVER

SPECIFICATIONS

Material Reinforced Polyamide

Component Reference

SL/N/SIM

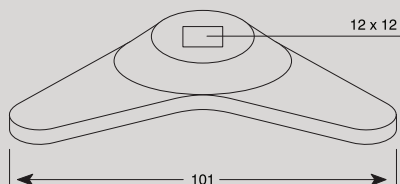

CHAIN GUIDE / TENSIONERS

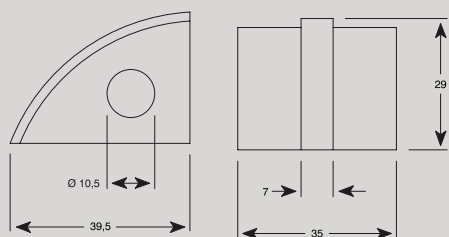

SPECIFICATIONS

Material: UHMWPE

Component Reference

CHAIN/GUIDE/39.5

CHAIN GUIDE / TENSIONERS

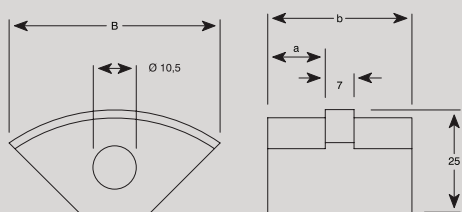
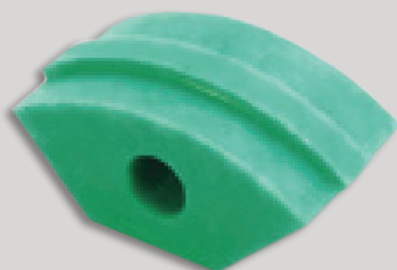

SPECIFICATIONS

Material: Polyamide/ UHMWPE

Component Reference	Dimensions (mm)		
	B	b	a
CHAIN/GUIDE/35	51.3	35	14
CHAIN/GUIDE/30	53.8	30	10

TURNING / FORK ALTERNATIVE

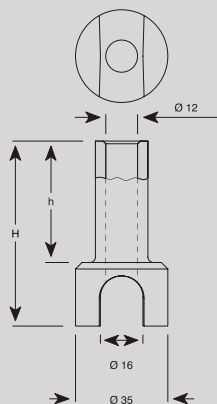

SPECIFICATIONS

Material: Polyamide/ UHMWPE

Component Reference	Dimensions	
	H	h
TURNING/FORK/52	52	28
TURNING/FORK/67	67	43
TURNING/FORK/70	70	46

KHS & KRONES ALTERNATIVE BOTTLE PLATFORMS

SPECIFICATIONS

Material: Stainless steel & polyurethane with high abrasion resistance

Component Reference	Dimensions (mm)		
	A	B	C
BOTTLE/PLATFORM/85	85	78.5	-
BOTTLE/PLATFORM/85-6	85	78.5	6
BOTTLE/PLATFORM/92	92	85.5	-

KHS & KRONES ALTERNATIVE BOTTLE PADS

SPECIFICATIONS

Material: Reinforced Polyamide

Component Reference	Dimensions (mm)		
	A	B	C
BOTTLE/PAD/55	55	57	100
BOTTLE/PAD/55-80	55	57	80
BOTTLE/PAD/48	48	50	100

KHS & KRONES ALTERNATIVE BOTTLE PADS

SPECIFICATIONS

Material: Polyamide/ UHMWPE

Component Reference	Dimensions (mm)			
	A	B	H	h
BOTTLE/PAD/79.5	74.7	79.5	26	21.6
BOTTLE/PAD/85	80	85	14	6
BOTTLE/PAD/88	81	88	20	10
BOTTLE/PAD/87	82	87	15	6
BOTTLE/PAD/95	90	95	26.5	21
BOTTLE/PAD/98	91	98	20	10
BOTTLE/PAD/100	95	100	14	6
BOTTLE/PAD/105	100	105	14	6
BOTTLE/PAD/108	101	108	20	10

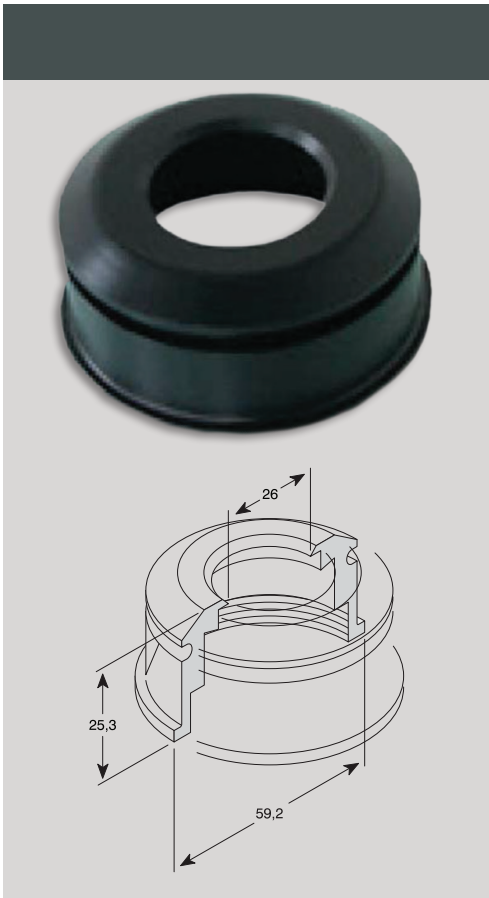

**KHS, KRONES & SIDEL ALTERNATIVE
UPPER PART OF CENTERING TULIP**

SPECIFICATIONS

Material	Reinforced Plastic
----------	--------------------

Component Reference	UPPER/TULIP
---------------------	-------------



**KHS, KRONES & SIDEL ALTERNATIVE
LOWER PART OF CENTERING TULIP**

SPECIFICATIONS

Material	Reinforced Plastic
----------	--------------------

Component Reference	LOWER/TULIP
---------------------	-------------

KHS & KRONES ALTERNATIVE SUCTION CUP / TULIP SLEEVE



SPECIFICATIONS

Material Injection Moulded Polyurethane

Component Reference

SUC/CUP/NT

KHS & KRONES ALTERNATIVE SUCTION CUP / TULIP SLEEVE



SPECIFICATIONS

Material Injection Moulded Polyurethane

Component Reference

SUC/CUP/TR

KRONES ALTERNATIVE PTFE BELLOWS / DIAPHRAGMS

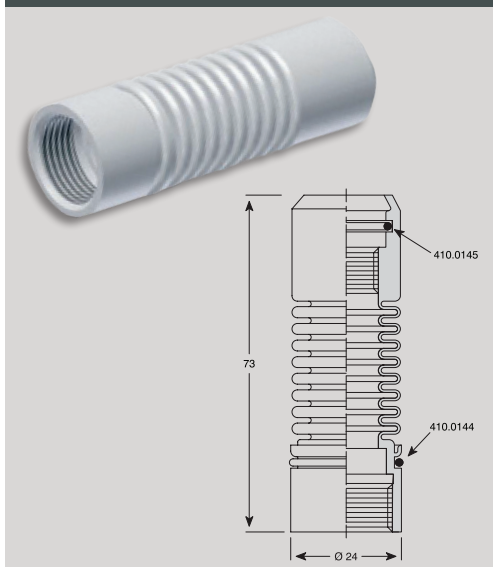

SPECIFICATIONS

Material PTFE

Component Reference

8-RING/PTFE/BELLOW

KHS & KRONES ALTERNATIVE LIFT ROLLERS

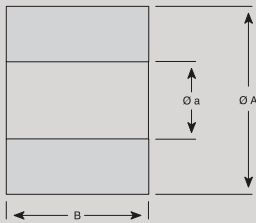

SPECIFICATIONS

Material: Polyamide, Acetal, UHMWPE

Component Reference	Dimensions (mm)		
	ØA	Øa	B
ROLLER/20ODX61DX10mm	20	6	10
ROLLER/25ODX12DX12mm	25	12	12
ROLLER/30ODX8.5DX17mm	30	8.5	17
ROLLER/30ODX12.5DX22.7mm	30	12.5	22.7
ROLLER/49.5ODX14DX13.5mm	49.5	14	13.5
ROLLER/50ODX24DX39mm	50	24	39

KHS & KRONES ALTERNATIVE LIFT ROLLERS

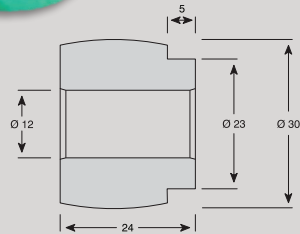

SPECIFICATIONS

Material: Polyamide, Acetal, UHMWPE

Component Reference
ROLLER/30OD/12ID/24mm

KHS & KRONES ALTERNATIVE LIFT ROLLERS

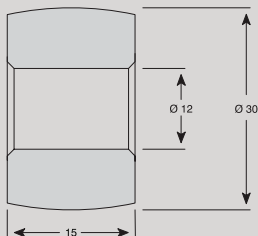

SPECIFICATIONS

Material: Polyamide, Acetal, UHMWPE

Component Reference
ROLLER/30OD/12ID/15mm

KHS & KRONES ALTERNATIVE LIFT ROLLERS

SPECIFICATIONS

Material Outer coating in Acetal/Polyamide to suit pressed fit bearings

Component Reference	Dimensions (mm)		
	ØA	Øa	B
ROLLER/40ODX12DX16mm	40	12	16
ROLLER/60ODX20DX20mm	60	20	20

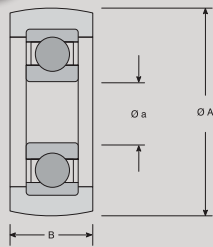

KHS & KRONES ALTERNATIVE LIFT ROLLERS

SPECIFICATIONS

Material Coating in Polyamide, Ball-Bearing

Component Reference
ROLLER/40OD/15ID/16mm

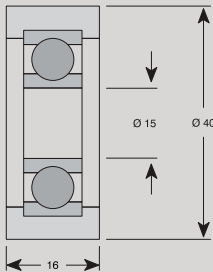
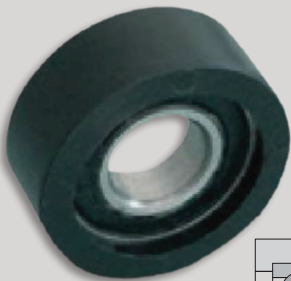

KHS & KRONES ALTERNATIVE LIFT ROLLERS

SPECIFICATIONS

Material Polyurethane - Polyamide

Component Reference
COATED/ROLLER/50OD

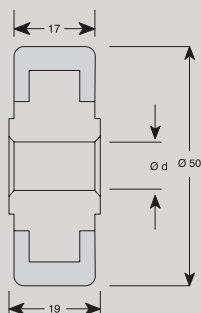
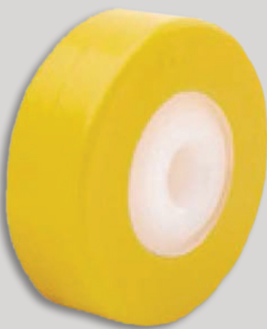

KHS & KRONES ALTERNATIVE LIFT ROLLERS

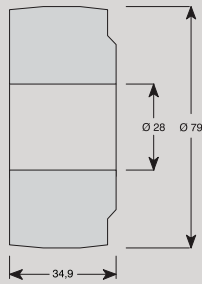

SPECIFICATIONS

Material Polyamide, Acetal, UHMWPE

Component Reference

ROLLER/79OD/28ID/34.9mm

KHS & KRONES ALTERNATIVE LIFT ROLLERS

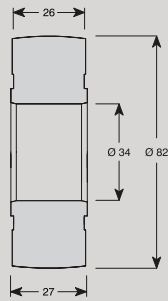

SPECIFICATIONS

Material Polyamide, Acetal, UHMWPE

Component Reference

ROLLER/82OD/34ID/27mm

KHS & KRONES ALTERNATIVE CAM FOLLOWER ROLLERS

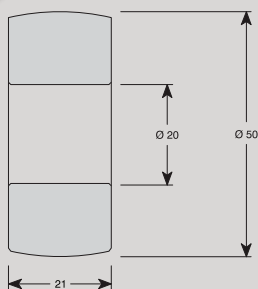

SPECIFICATIONS

Material Polyamide, Acetal, UHMWPE

Component Reference

ROLLER/82OD/20ID/21mm

KHS & KRONES ALTERNATIVE CAM FOLLOWER ROLLERS

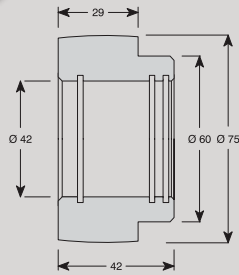
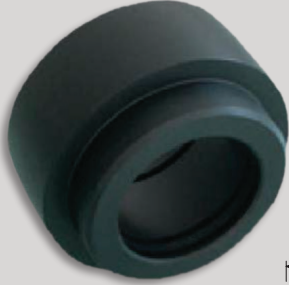

SPECIFICATIONS

Material Polyamide, Acetal, UHMWPE

Component Reference

ROLLER/75OD/60ID/42mm

KHS & KRONES ALTERNATIVE CAM FOLLOWER ROLLERS

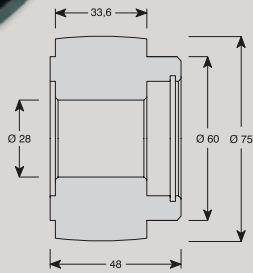
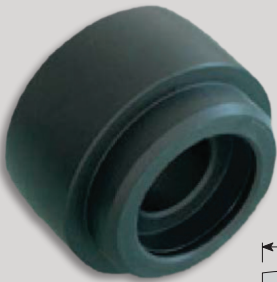

SPECIFICATIONS

Material Polyamide, Acetal, UHMWPE

Component Reference

ROLLER/70OD/60ID/48mm

KHS & KRONES ALTERNATIVE PULL DOWN ROLLERS

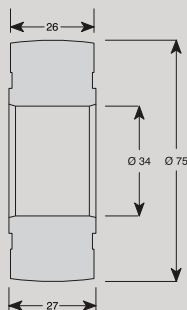

SPECIFICATIONS

Material Polyamide, Acetal, UHMWPE

Component Reference

ROLLER/75OD/34ID/27mm

KHS & KRONES ALTERNATIVE PULL DOWN ROLLERS

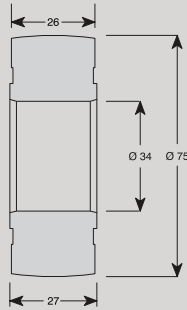
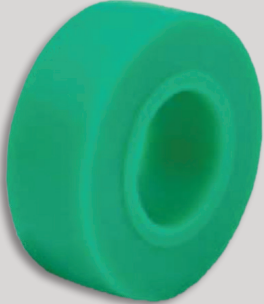

SPECIFICATIONS

Material Polyamide, Acetal, UHMWPE

Component Reference

ROLLER/75OD/34ID/27mm

KHS & KRONES ALTERNATIVE PULL DOWN ROLLERS

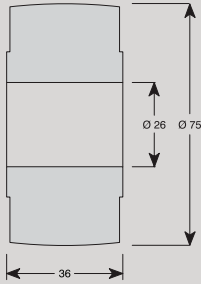
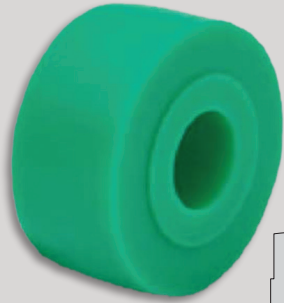

SPECIFICATIONS

Material Polyamide, Acetal, UHMWPE

Component Reference

ROLLER/75OD/26ID/36mm

KHS & KRONES ALTERNATIVE PULL DOWN ROLLERS

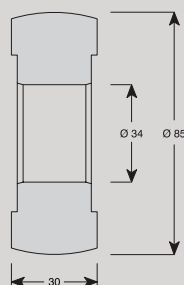
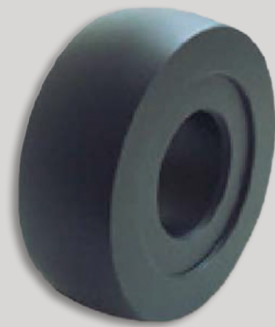

SPECIFICATIONS

Material Polyamide, Acetal, UHMWPE

Component Reference

ROLLER/85OD/34ID/30mm

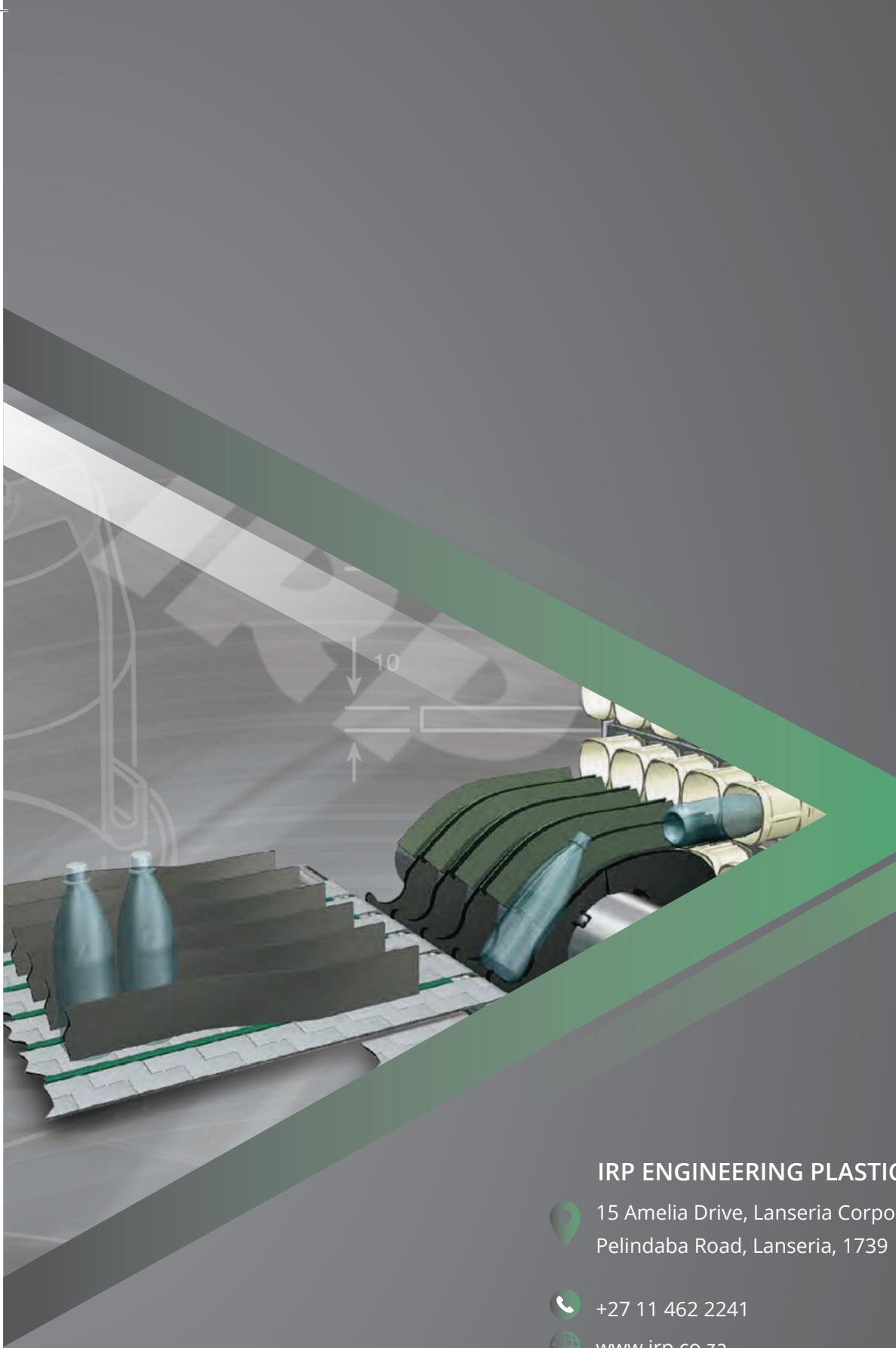

IRP ENGINEERING PLASTICS



15 Amelia Drive, Lanseria Corporate Estate,
Pelindaba Road, Lanseria, 1739



+27 11 462 2241



www.irp.co.za



Volume 22

JOHANNESBURG

PO Box 2666,
Honeydew, 2040

Tel: +27 11 462 2241
Fax: +27 11 462 4150
Email: jhb@irp.co.za

CAPE TOWN

PO Box 2666,
Honeydew, 2040

Tel: +27 21 556 6990
Fax: +27 21 556 7440
Email: capetown@irp.co.za

DURBAN

PO Box 2666,
Honeydew, 2040

Tel: +27 31 205 0200
Fax: +27 31 205 0203
Email: durban@irp.co.za

